

Wavefoam for Lenses
(for selected models only)



PRECAUTIONS

- ◆ Do not place any corrosive or flammable materials inside the cabinet
- ◆ Do not store food or medicine in this cabinet.
- ◆ This product is for indoor use only.

OPTIMAL RELATIVE HUMIDITY (RH) LEVELS

RH Level	Recommended items
55%-60%	Books, Paintings, Antique Documents, Paper (Fax, Copy, Print), Cigars etc.
40%-55%	Camcorders, camera, lenses, telescopes, microscopes, endoscopes, compact discs, film negatives, film, transparency/slides, microfilm, disk drives, audio and video tapes, Musical instruments, leather products etc.
30%-40%	Metal and metal powder products, electrical equipment, semiconductors, capacitors, printed circuit boards, IC, batteries and other electronics equipment, precision measuring tools, spectrometers, etc.
Below 30%	Pharmaceutical raw materials, spices, powder coating, adhesives, seeds, pollen, dry flour, dry flowers, etc

DISTRIBUTED BY:

DIGIHUB
S I N G A P O R E

Digihub Singapore Pte Ltd
www.digihub.com.sg / www.digicabi.com.sg
Tel: 64510010

Digi-Cabi Dry Cabinet INSTRUCTION MANUAL



THANK YOU FOR CHOOSING DIGI-CABI/I-CABI DRY CABINETS

The Digi-Cabi Electronic Dry Cabinet protects your lenses, photographic and optical equipment, mobile electronics, leather products and other valuable accessories from excessive moisture.

Digi-Cabi uses the “cold-chip” technology to regulate the interior’s relative humidity. It helps to prevent fungus and corrosion from damaging your equipment.

The Cold Chip cools a metal surface to induce condensation of air moisture from gaseous state to liquid state. The water collected will be evaporated through the vent and renders the enclosed environment dry. The cabinet operates silently without any fan or compressor. The tempered glass door and magnetic rubber seal provide extra protection against dust, prolonging the lifespan of your gear.

SETTING UP

- ◆ Place cabinet in a well ventilated area to facilitate evaporation to take place.
- ◆ Leave a gap of at least 5cm against wall for evaporation.
- ◆ Make sure that the power cable is plugged in securely before turning on power.
- ◆ Keep this product away from direct sunlight, high temperature and windy environments.

ADJUSTING TRACKS AND TRAYS

◆ For 20L and 30L

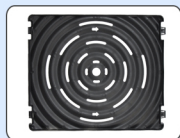

1) Locate arrow on tray. Ensure that the arrow is pointing to the right.

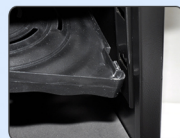
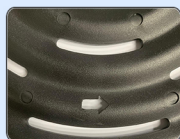

2) Tilt tray at an angle and insert right knob into desired level.

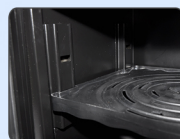

3) Level the tray to the same and insert left knob in.

◆ For AD, DHC & ATS Series



1) Pull out tray and lift tray at a 45° angle to remove tray from the track.



2) Lift the track upwards at a 90° angle to remove track for the cabinet.



3) To put back the tracks into cabinet, place track at the desired level and insert it into the holes with the roller track facing upwards and then turn downwards to lock the track in place. Place tray at a 45° angle at the front of the track and push gently to put tray back into the track.

CONTROL SETTINGS

A) I-Cabi Models (20L,30L)

- ◆ Uses an analog or battery operated LCD Hygrometer

After switching on power, please adjust the setting on the dehumidifier (L, H or M)

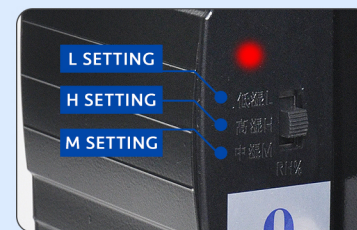

- ◆ **L setting** – Suction power high, Humidity level lower (30 - 40%)
- ◆ **H setting** – Suction power low, Humidity level higher (45 - 55%)
- ◆ **M setting** – Suction power medium, Humidity level moderate (40 - 50%)

B) DB/AD Series (30L to 500L)

- ◆ Uses a direct power LED hygrometer. Reading on the hygrometer will be lighted for about 30secs then dimmed off. Press “Light Bulb” button to light up again.

After switching on power, Red LED light represents power supply, Green LED Light represents suction power of dehumidifier.

By turning dial, you can adjust the humidity setting that you want. (Green, Blue or Red Zone)

- ◆ **Green Zone** – Suction power low, Humidity level higher (55-60%)
- ◆ **Blue Zone (Recommended)** – Suction power medium, Humidity level moderate (40-55%)
- ◆ **Red Zone** – Suction power high, Humidity level lower (35-45%)

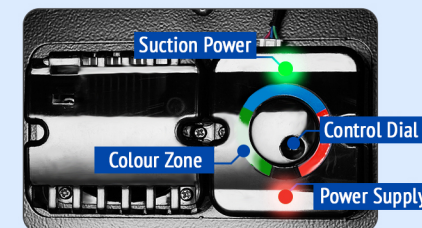

C) DHC Series (50L to 1200L) / ATS Series (80L to 160L)

- ◆ Uses a digital controlled LED Hygrometer

After switching on power, the hygrometer will be lighted up and a red LED light will be lighted on the dehumidifier to represent power supply.

- ◆ “S” Button to set humidity level. Press “S” button once and the % reading on display will start to flick
 - ◆ Adjust the humidity level by pressing “Up” or “Down” button until required humidity % is shown
 - ◆ Press “S” button again to confirm setting
- *Light Switch is only for ATS models

